

Profile 3035-O

Ref. A08441

Ref. arch B8441

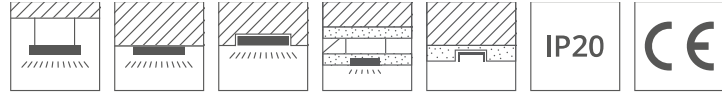
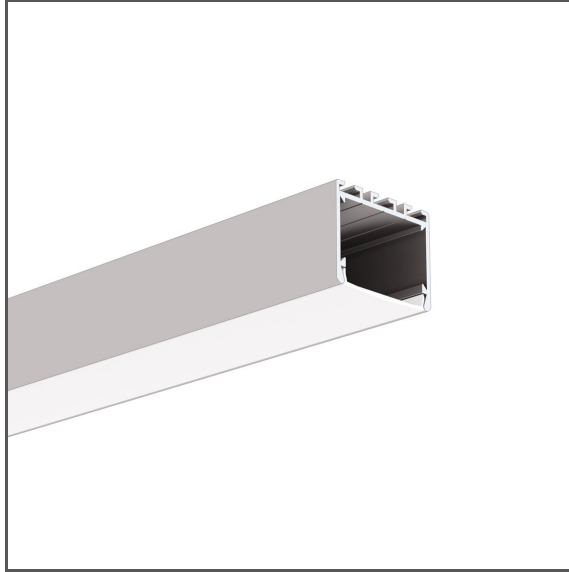

- Smooth profile walls
- Wide range of accessories

APPLICATION

- main and decorative lighting

MOUNTING

- to the surface or suspended, using dedicated accessories or properly selected screws
- can be easily connected into runs and systems

ADDITIONAL INFORMATION

- standard lengths of KLUŚ profiles and covers: 1000 mm (tolerance ± 1.5 mm) and 2005 mm / 3010 mm (tolerance + 5 mm); for selected covers: 6050 mm, 10050 mm (tolerance + 5 mm)
- when choosing a different length of profiles / covers than available in the standard, you should additionally choose the cutting service at KLUŚ

TECHNICAL DRAWING

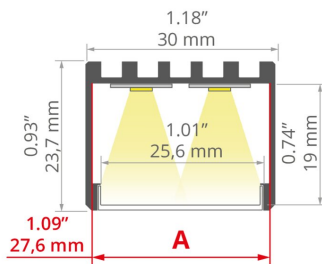

TECHNICAL SPECIFICATIONS

Material	aluminum
Color	■ silver anodized
Possible fixture IP	20
Possible fixture shapes	linear, polygonal
Profile cross-section	rectangular
Width	30 mm
Height	23.7 mm
LED gluing width A	27.6 mm
Number of LED strips A (8 mm wide)	3
Possibility of obtaining a line of light	yes
Building type	Commercial, Retail, Entertainment/ Arts, HoReCa object
Facility zone	office, communication routes and corridors, conference room, lobby / foyer
The cover is cut to the length of the profile	yes
Can be easily connected into runs	yes
Wire out back of extrusion	yes

Length	Ref
1000 mm	A08441A_1 B8441ANODA_1
2005 mm	A08441A_2 B8441ANODA_2
3010 mm	A08441A_3 B8441ANODA_3

Profile 3035-O

Ref. A08441

Ref. arch B8441

SAMPLE PROJECTS

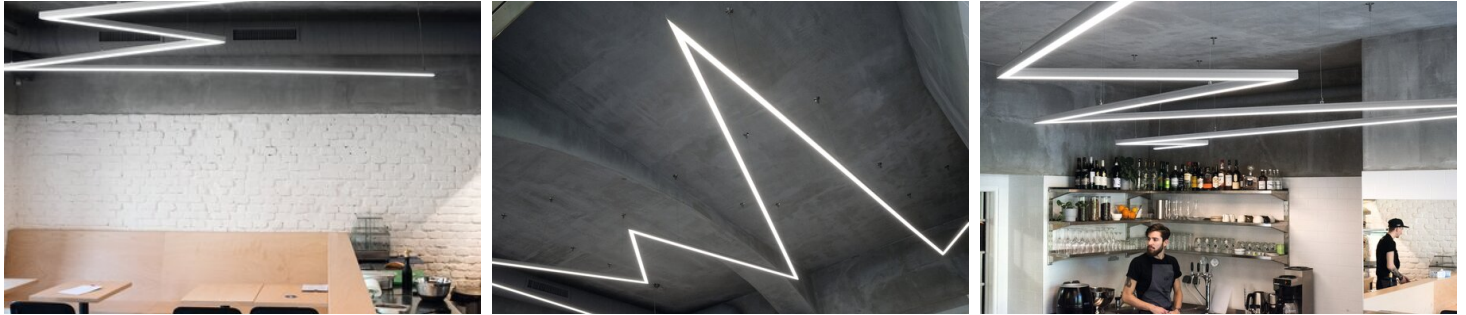

RELATED PROFILES > MOUNTING TRACKS



RAM-3035-KOZE



A18056

Ref. arch 18056

RELATED ACCESSORIES > RELATED COVERS

NAME		MATERIAL	MATERIAL TRANSMITTANCE	COLOR	REF.
3035		PC	62 %	<input type="checkbox"/> frosted	B17141M 17141

RELATED ACCESSORIES > RELATED END CAPS

NAME		MATERIAL	COLOR	REF.
3035-O		ABS	<input checked="" type="checkbox"/> gray	C24274C02 24274
3035-O-HQ		aluminum	<input checked="" type="checkbox"/> silver	C28217AS 42625

Profile 3035-O

Ref. A08441

Ref. arch B8441

RELATED ACCESSORIES > RELATED LED

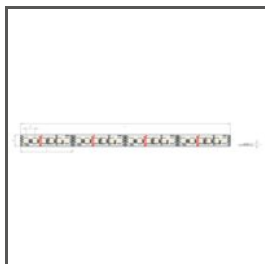

K-1200-120-RGB-24V

_błąd

Ref. arch K-1200-120-RGB-24V

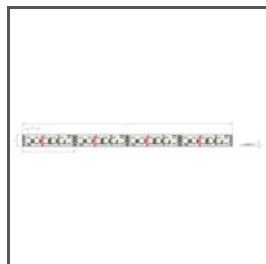

K-0700-120-RGB-24V

_błąd

Ref. arch K-0700-120-RGB-24V

RELATED ACCESSORIES > RELATED LED > BENDABLE



K-BT-RGB40-1510-24V

K-BTRGB40-1510-24

Ref. arch K-BT-RGB40-1510-24V

RELATED ACCESSORIES > RELATED LED > CRI 95+

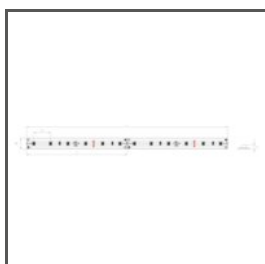

K-CR-1210-24V

K-CR-1210-24

Ref. arch K-CR-1210-24V

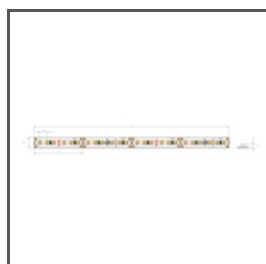

K-CR-1220-24V

K-CR-1220-24

Ref. arch K-CR-1220-24V

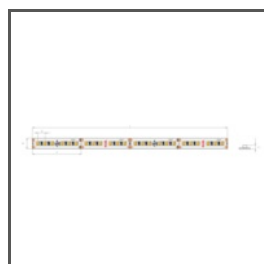

K-CR-1275-24V

K-CR-1275-24

Ref. arch K-CR-1275-24V

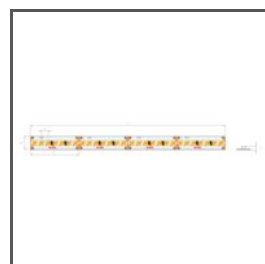

K-CR-1820-HD-24V

K-CRHD-1820-24

Ref. arch K-CR-1820-HD-24V

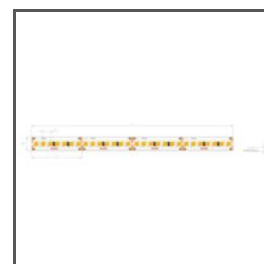

K-CR-1910-HD-24V

K-CRHD-1910-24

Ref. arch K-CR-1910-HD-24V

RELATED ACCESSORIES > RELATED LED > DIM TO WARM



K-27/50-1440-24V

K-27/50-1440-24

Profile 3035-O

Ref. A08441

Ref. arch B8441

RELATED ACCESSORIES > RELATED LED > HIGH EFFICACY

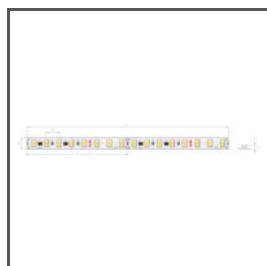

K-HE-0480-HD-24V
K-HEHD-0480-24
Ref. arch K-HE-0480-HD-24V

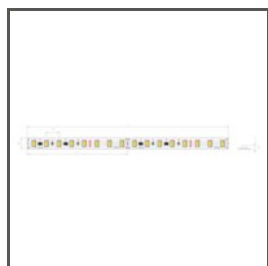

K-HE-0960-HD-24V
K-HEHD-0960-24
Ref. arch K-HE-0960-HD-24V



K-HE-1440-HD-24V
K-HEHD-1440-24
Ref. arch K-HE-1440-HD-24V

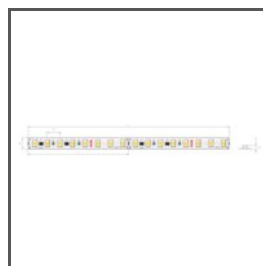

K-HE-1920-HD-24V
K-HEHD-1920-24
Ref. arch K-HE-1920-HD-24V

RELATED ACCESSORIES > RELATED LED > RGB / RGB-W / RGB-CTT

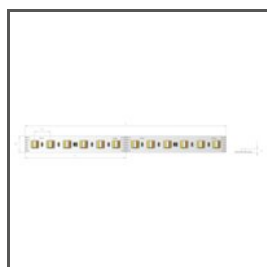

K-1200-RGB+27/65-24V
K-RGB27/65-1200-24
Ref. arch K-1200-RGB+27/65-24V



K-1530-RGB+W-24V
K-RGBW-1530-24
Ref. arch K-1530-RGB+W-24V

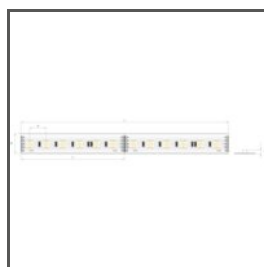

K-1920-120-RGB-24V
K-RGB-1920-120-24
Ref. arch K-1920-120-RGB-24V



K-RGB-1200-24V
K-RGB-1200-24
Ref. arch K-RGB-1200-24V



K-RGB-0700-24V
K-RGB-700-24V
Ref. arch K-RGB-0700-24V

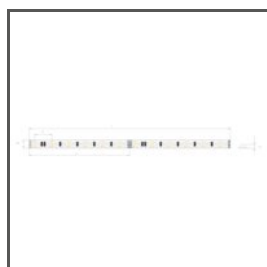

K-1560-RGB-24V
K-RGB-1560-24
Ref. arch K-1560-RGB-24V

RELATED ACCESSORIES > RELATED LED > WHITE MONO



K-0530-HD-24V
K-HD-0530-24
Ref. arch K-0530-HD-24V



K-0480-24V
K-0480-24
Ref. arch K-0480-24V



K-0960-24V
K-0960-24
Ref. arch K-0960-24V



K-1440-24V
K-1440-24
Ref. arch K-1440-24V

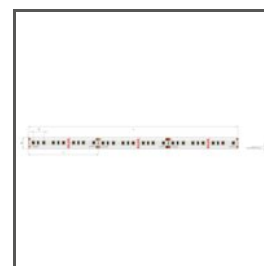

K-VHE-0960-24 - nie wdrażane
K-VHE-0960-24

Profile 3035-O

Ref. A08441

Ref. arch B8441

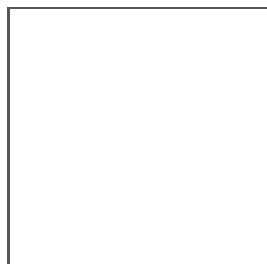

K-VHE-0480-24 - nie wdrażane_bład
Ref. arch K-VHE-0480-24



K-2400-24
K-2400-24



K-VBT-0480-24_bład
Ref. arch K-VBT-0480-24

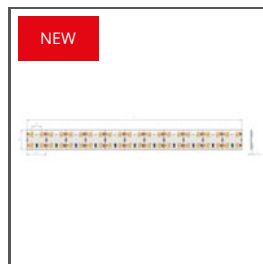

K2-1920-24
K2-1920-24



K3-2880-24
K3-2880-24

RELATED ACCESSORIES > OTHER RELATED ACCESSORIES > ADDITIONAL ITEMS

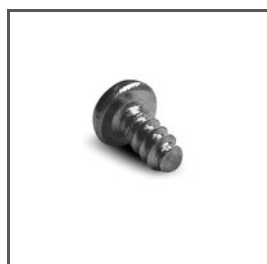

SCREW
2.9X6.5 DIN7981F
Z70283
Ref. arch 70283

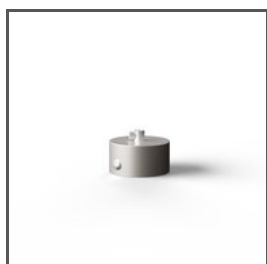

CANOPY
Fi-60mm
C24540

RELATED ACCESSORIES > OTHER RELATED ACCESSORIES > CONDUCTIVE FASTENERS AND HEADS FOR PROFILES



FASTENER
PUSZ-PRET-ZM
C28161N00, C28161L10,
C28161L07
Ref. arch 42276, 42276L9010,
42276L9005



FASTENER
FI-8-LIN-ZMZ
C28171N00, C28171L10,
C28171L07
Ref. arch 42286, 42286L9010,
42286L9005



FASTENER
PUSZ-LIN-ZM
C28160N00, C28160L10,
C28160L07
Ref. arch 42275, 42275L9010,
42275L9005



FASTENER
PUSZ-LIN-MR
C28163N00, C28163L10,
C28163L07
Ref. arch 42278, 42278L9010,
42278L9005

RELATED ACCESSORIES > OTHER RELATED ACCESSORIES > CONNECTORS



CONNECTOR
ZM-60
C28243N00
Ref. arch 42736

Profile 3035-O

Ref. A08441

Ref. arch B8441

RELATED ACCESSORIES > OTHER RELATED ACCESSORIES > FASTENERS AND HEADS FOR PROFILES



HEAD
BZP
C28113N00
Ref. arch 42213



FASTENER
FI-10-ZM-P
C28117N00
Ref. arch 42244



FASTENER
FI-10-ZM-W
C28116N00
Ref. arch 42242



FASTENER
DP-45-MOC
C28256N00
Ref. arch 00652



FASTENER
FI-8-LIN-ZM
C28170N00, C28170L10,
C28170L07
Ref. arch 42285, 42285L9010,
42285L9005

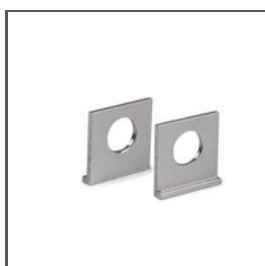

FASTENER
UCHO-ZM
C28192N00, C28192L07
Ref. arch 42512, 42525



FASTENER
FI-8-PRET-ZM
C28189
Ref. arch 42347

RELATED ACCESSORIES > OTHER RELATED ACCESSORIES > OTHER



GLAND
6,4x3
C42264C07
Ref. arch 42264

RELATED ACCESSORIES > OTHER RELATED ACCESSORIES > SECURITY AND BLOCKS

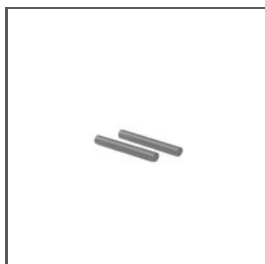

BLOCK
ZM
C28194N00
Ref. arch 42520

Profile 3035-O

Ref. A08441

Ref. arch B8441

RELATED ACCESSORIES > OTHER RELATED ACCESSORIES > SURFACE SPRINGS

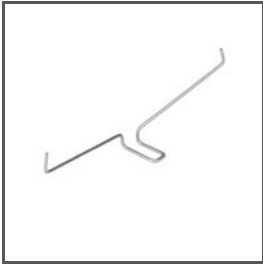

SPRING

GP

C24500N00

Ref. arch 00293

RELATED ACCESSORIES > OTHER RELATED ACCESSORIES > SUSPENSION AND MOUNTING SETS



FASTENER SET

W1

C28203N00

Ref. arch 42602



FASTENER SET

W2

C28204N00

Ref. arch 42603



FASTENER SET

W6

C28205N00

Ref. arch 42604



FASTENER SET

RD-1

C28231

Ref. arch 42658NI, 42658GSS,
42658L9005, 42658L9010



FASTENER SET

RG-1

C28230P00, C28230P01,
C28230L10, C28230L07

Ref. arch 42647NI, 42647GSS,
42647L9010, 42647L9005



FASTENER SET

RD-3

C28233P00, C28233P01,
C28233L10, C28233L07

Ref. arch 42659NI, 42659GSS,
42659L9010, 42659L9005



FASTENER SET

RD-2

C28232P00, C28232P01,
C28232L10, C28232L07

Ref. arch 42653NI, 42653GSS,
42653L9010, 42653L9005



FASTENER SET

RD-4

C28234P00, C28234P01,
C28234L10, C28234L07

Ref. arch 42657NI, 42657GSS,
42657L9010, 42657L9005