

Profile OPK-4

Ref. A00370

Ref. arch C0370

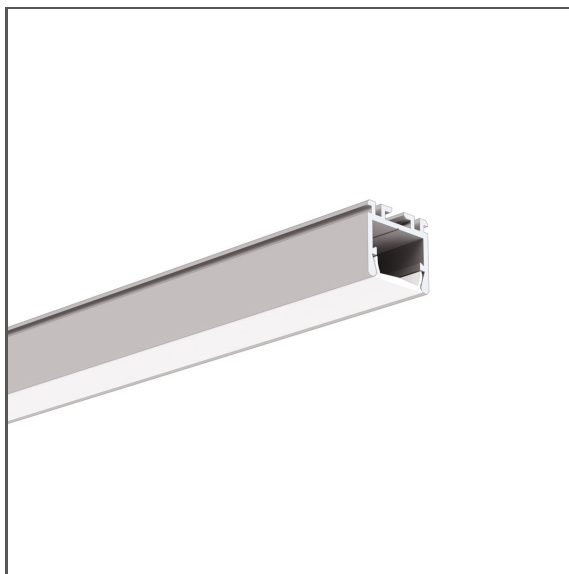

- Wide range of accessories
- Easy maintenance
- Small bending radius

APPLICATION

- main and decorative lighting

MOUNTING

- recessed, using a dedicated mounting track
- can be easily connected into runs and systems

ADDITIONAL INFORMATION

- disassembly from the mounting track using special plates
- smooth transition from a recessed into a suspended fixture
- standard lengths of KLUŚ profiles and covers: 1000 mm (tolerance ± 1.5 mm) and 2005 mm / 3010 mm (tolerance + 5 mm); for selected covers: 6050 mm, 10050 mm (tolerance + 5 mm)
- when choosing a different length of profiles / covers than available in the standard, you should additionally choose the cutting service at KLUŚ

TECHNICAL DRAWING

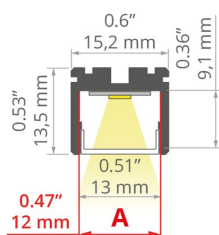

TECHNICAL SPECIFICATIONS

Material	aluminum
Color	■ silver anodized
Possible fixture IP	20, 67
Possible fixture shapes	linear, polygonal
Profile cross-section	rectangular
Width	15.2 mm
Height	13.5 mm
LED gluing width A	12 mm
Number of LED strips A (8 mm wide)	1
Possibility of obtaining a line of light	yes
Possibility of bending	yes
Minimum external radius	300 mm
Minimum internal radius	300 mm
Building type	Residential, Retail, HoReCa object
Facility zone	kitchen, furniture, communication routes and corridors
The cover is cut to the length of the profile	yes

Length	Ref
1000 mm	A00370A_1 C0370ANODA_1
2005 mm	A00370A_2 C0370ANODA_2
3010 mm	A00370A_3 C0370ANODA_3

Profile OPK-4

Ref. A00370

Ref. arch C0370

Can be easily connected into runs	yes
Mounting to drywall	yes
Wire out back of extrusion	yes

SAMPLE PROJECTS



RELATED PROFILES > MOUNTING TRACKS







TPK-4
A18044
Ref. arch 18044

Profile OPK-4

Ref. A00370

Ref. arch C0370

RELATED ACCESSORIES > RELATED COVERS

NAME	MATERIAL	MATERIAL TRANSMITTANCE	COLOR	REF.
LIGER		PC	70 % <input type="checkbox"/> frosted	B17037M 17037
			32 % <input checked="" type="checkbox"/> black	B17037C 17040
KA-COM		PVC	70 % <input type="checkbox"/> frosted	B17179M 17179
			93 % <input checked="" type="checkbox"/> clear	B17179T 17180
HS		PC	73 % <input type="checkbox"/> frosted	B17208M 1369
			94 % <input checked="" type="checkbox"/> clear	B17208T 1370
KA-PRO		PC	67 % <input type="checkbox"/> frosted	B17064M 17064
			94 % <input checked="" type="checkbox"/> clear	B17064T 17065
KA		PC	63 % <input type="checkbox"/> frosted	B17035M 17035
			91 % <input checked="" type="checkbox"/> clear	B17035T 17036

RELATED ACCESSORIES > RELATED END CAPS

NAME	MATERIAL	COLOR	REF.
OPK-4	 ABS	<input checked="" type="checkbox"/> gray	C24238C02 24238

RELATED ACCESSORIES > OTHER RELATED ACCESSORIES > ADDITIONAL ITEMS

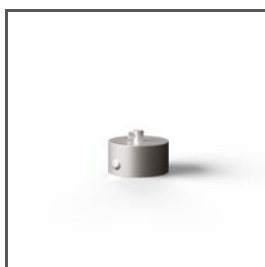

CANOPY
Fi-60mm
C24540

Profile OPK-4

Ref. A00370

Ref. arch C0370

RELATED ACCESSORIES > OTHER RELATED ACCESSORIES > CONDUCTIVE FASTENERS AND HEADS FOR PROFILES



FASTENER
PUSZ-LIN-ZM
C28160N00, C28160L10,
C28160L07
Ref. arch 42275, 42275L9010,
42275L9005



FASTENER
FI-8-LIN-ZMZ
C28171N00, C28171L10,
C28171L07
Ref. arch 42286, 42286L9010,
42286L9005



FASTENER
PUSZ-PRET-ZM
C28161N00, C28161L10,
C28161L07
Ref. arch 42276, 42276L9010,
42276L9005



FASTENER
PUSZ-LIN-MR
C28163N00, C28163L10,
C28163L07
Ref. arch 42278, 42278L9010,
42278L9005

RELATED ACCESSORIES > OTHER RELATED ACCESSORIES > CONNECTORS



CONNECTOR
ZM-60
C28243N00
Ref. arch 42736

RELATED ACCESSORIES > OTHER RELATED ACCESSORIES > FASTENERS AND HEADS FOR PROFILES



HEAD
BZP
C28113N00
Ref. arch 42213



FASTENER
FI-8-LIN-ZM
C28170N00, C28170L10,
C28170L07
Ref. arch 42285, 42285L9010,
42285L9005



FASTENER
FI-10-ZM-P
C28117N00
Ref. arch 42244



FASTENER
FI-10-ZM-W
C28116N00
Ref. arch 42242

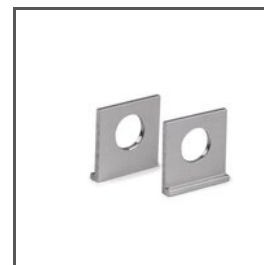

FASTENER
UCHO-ZM
C28192N00, C28192L07
Ref. arch 42512, 42525

RELATED ACCESSORIES > OTHER RELATED ACCESSORIES > OTHER



GLAND
6x1,2
C24517C07
Ref. arch 00802

Profile OPK-4

Ref. A00370

Ref. arch C0370

RELATED ACCESSORIES > OTHER RELATED ACCESSORIES > SECURITY AND BLOCKS

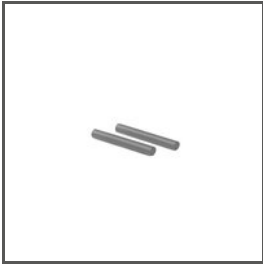

BLOCK

ZM

C28194N00

Ref. arch 42520

RELATED ACCESSORIES > OTHER RELATED ACCESSORIES > SURFACE SPRINGS

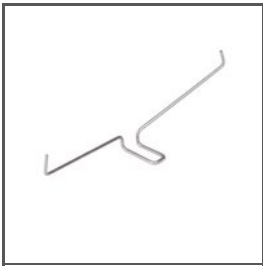

SPRING

GP

C24500N00

Ref. arch 00293

RELATED ACCESSORIES > OTHER RELATED ACCESSORIES > SUSPENSION AND MOUNTING SETS



FASTENER SET

W1

C28203N00

Ref. arch 42602

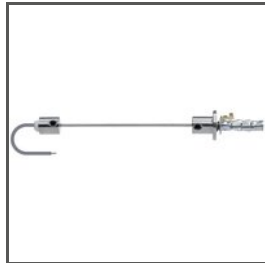

FASTENER SET

W2

C28204N00

Ref. arch 42603



FASTENER SET

W6

C28205N00

Ref. arch 42604



FASTENER SET

RD-1

C28231

Ref. arch 42658NI, 42658GSS,
42658L9005, 42658L9010



FASTENER SET

RG-1

C28230P00, C28230P01,

C28230L10, C28230L07

Ref. arch 42647NI, 42647GSS,
42647L9010, 42647L9005



FASTENER SET

RD-2

C28232P00, C28232P01,
C28232L10, C28232L07

Ref. arch 42653NI, 42653GSS,
42653L9010, 42653L9005



FASTENER SET

RD-3

C28233P00, C28233P01,
C28233L10, C28233L07

Ref. arch 42659NI, 42659GSS,
42659L9010, 42659L9005



FASTENER SET

RD-4

C28234P00, C28234P01,
C28234L10, C28234L07

Ref. arch 42657NI, 42657GSS,
42657L9010, 42657L9005